

Softsynchro® Micro



Short description

The new Softsynchro® Micro tap holders are designed especially for small taps from M 0.5 to M 4, and extend the known application range of the Softsynchro® series down to the smallest threads which can be produced today.

As with the successful larger designs, a minimum length compensation serves to compensate discrepancies between the feed on the side of the machine tool and the pitch of the tap.

Tap clamping is provided by means of cylindrical collets in the size ER 8. The target application sector for these mini size tap holders is the Mini and Micro component industry, represented by watch makers, the medical or the electrical industry.

Characteristics

- Size: Softsynchro® Micro
- Cutting range: M 0.5 - M 4 / dia. 2 - 4.5 mm
- Length compensation range: ± 0.2 mm
- Collet adaptation: ER 8
- Clamping nut: Hi-Q/ERM 8
- Coolant-lubricant supply: External
- Shank standards:
 - Cylindrical shank dia. 10h6, long design
 - Cylindrical shank dia. 10h6, short design acc. DIN 1835 A
 - Cylindrical shank dia. 10h6, design acc. DIN 1835 B+E
 - Hollow taper shank HSK 32, design acc. DIN 69893 A
 - Further shank designs available upon request

Clamping depth E with clamping nut Hi-Q/ERM 8

| Taps / cold-forming taps | | Shank dia. D ₁ [mm] | Square [mm] | Clamping depth E with Hi-Q/ERM 8 [mm] | |
|--------------------------|-------------------|--------------------------------------|----------------|---|------|
| DIN 371 | DIN 374 / DIN 376 | | | min. | max. |
| M0.5 - M0.9 | - | 2 | - | 9 | 20 |
| - | M 3 | 2.2 | - | 9 | 20 |
| M 1 - M 1.8 | M 3.5 | 2.5 | 2.1 | 14 | 20 |
| M 2 - M 2.6 | M 4 | 2.8 | 2.1 | 15 | 20 |
| M 3 | - | 3.5 | 2.7 | 15 | 19.5 |
| M 3.5 | - | 4 | 3 | 15 | 19 |
| M 4 | - | 4.5 | 3.4 | 15 | 19 |

Softsynchro® Micro with cylindrical shank dia. 10h6, long design

Article no.: F3150901

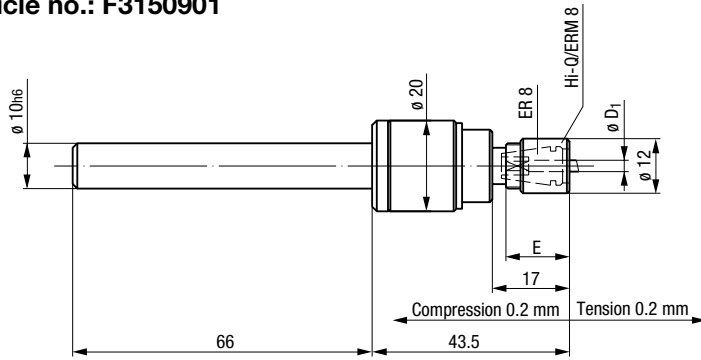

Softsynchro® Micro with cylindrical shank dia. 10h6, short design acc. DIN 1835 A

Article no.: F3150900

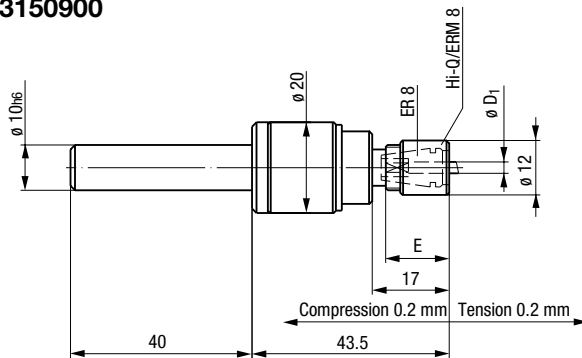

Softsynchro® Micro with cylindrical shank dia. 10h6, design acc. DIN 1835 B+E

Article no.: F3150G22

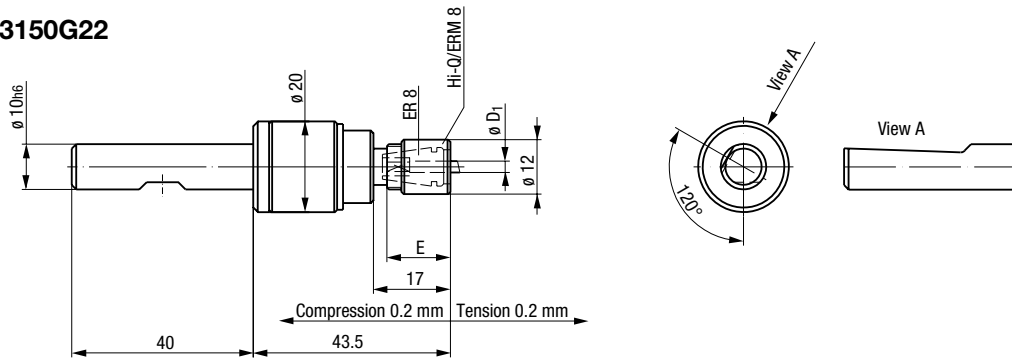

Softsynchro® Micro with hollow taper shank HSK 32, design acc. DIN 69893 A

Article no.: F3150C01

